

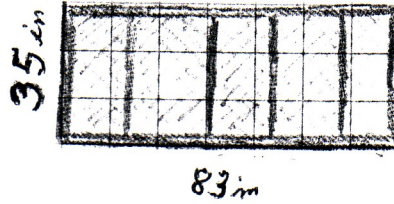

Red Bluff Pigeon Club

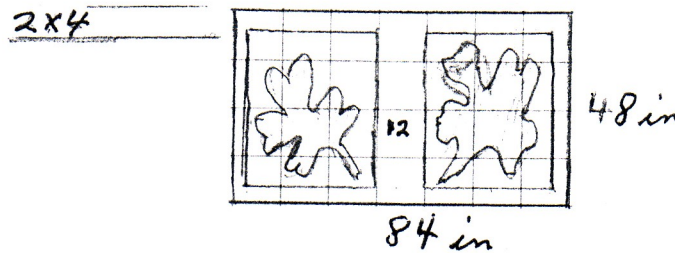

- I. Is the bottom, the size is 35" x 83" and needs to have a good wire on it. 1" x 1" is the preferred size.



- II. Is a full sheet of wood 48" x 84". You can cut your doors out of this and the middle part is 12". You will put a 2x4 or 2x2 across the top.

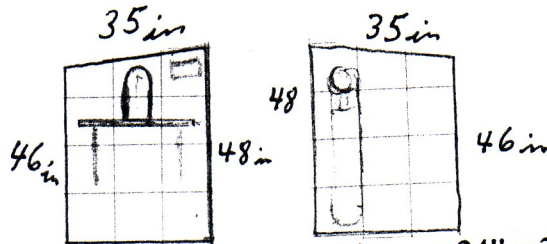

- III. Both sides are exactly the same. On one end is your 24" x 24" landing board and the opening for your electronic pad. In the corner is where the clock goes. On the other end is your feeder. Water is located in the center of the loft.

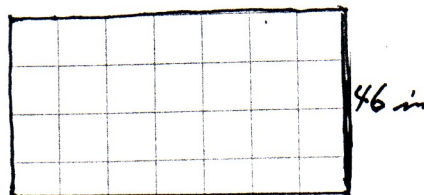

- IV. This is just the back of the loft - 46" x 84", a 2x2 or 2x4 across the top. You will need 4 - 2x4's for the legs and you adjust to the size of person. You will have 35 perches 5 and 5/8 which is a 2x4.

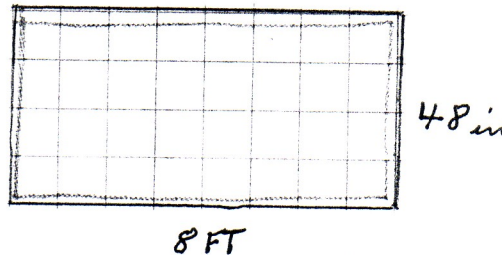

- V. This is a 48" x 96" sheet of wood which makes the roof. We have made rolled roofing and metal roofing and both need flashing.

Shafer Style 'Lean-In' loft.

Designed to hold up to 10 Young birds, be easy to maintain and clean and require a minimum amount of space and materials to build.

(Remember to always build with extra perches) The perches are attached to the wall and are designed to be very little if any scraping as most droppings will drop through the wire to the ground. Rake once a week.

Loft is mounted on 4- posts that can be adjusted to the height of young flyer with the floor of loft at waist level.

Use no larger than 1" welded wire or mesh, no smaller than $\frac{1}{2}$ "

Doweling for end feeders and water is $\frac{1}{4}$ "-1/2" dowels on 1-1/2" centers.

Attach shelf to bottom of loft if using plastic gutter material or plastic trays.

Position shelf so top of tray is approximately 2-3" above floor. This makes it easier for birds to drink.

The Trap should be a minimum of 4"W x 7" tall, with two Aluminum Bobs that are spaced 1.5 -2" apart. (Use pigeon bands or washers for spacers as needed.). It is recommended that a "weather door" be attached so traps can be shut at night to keep out predators.

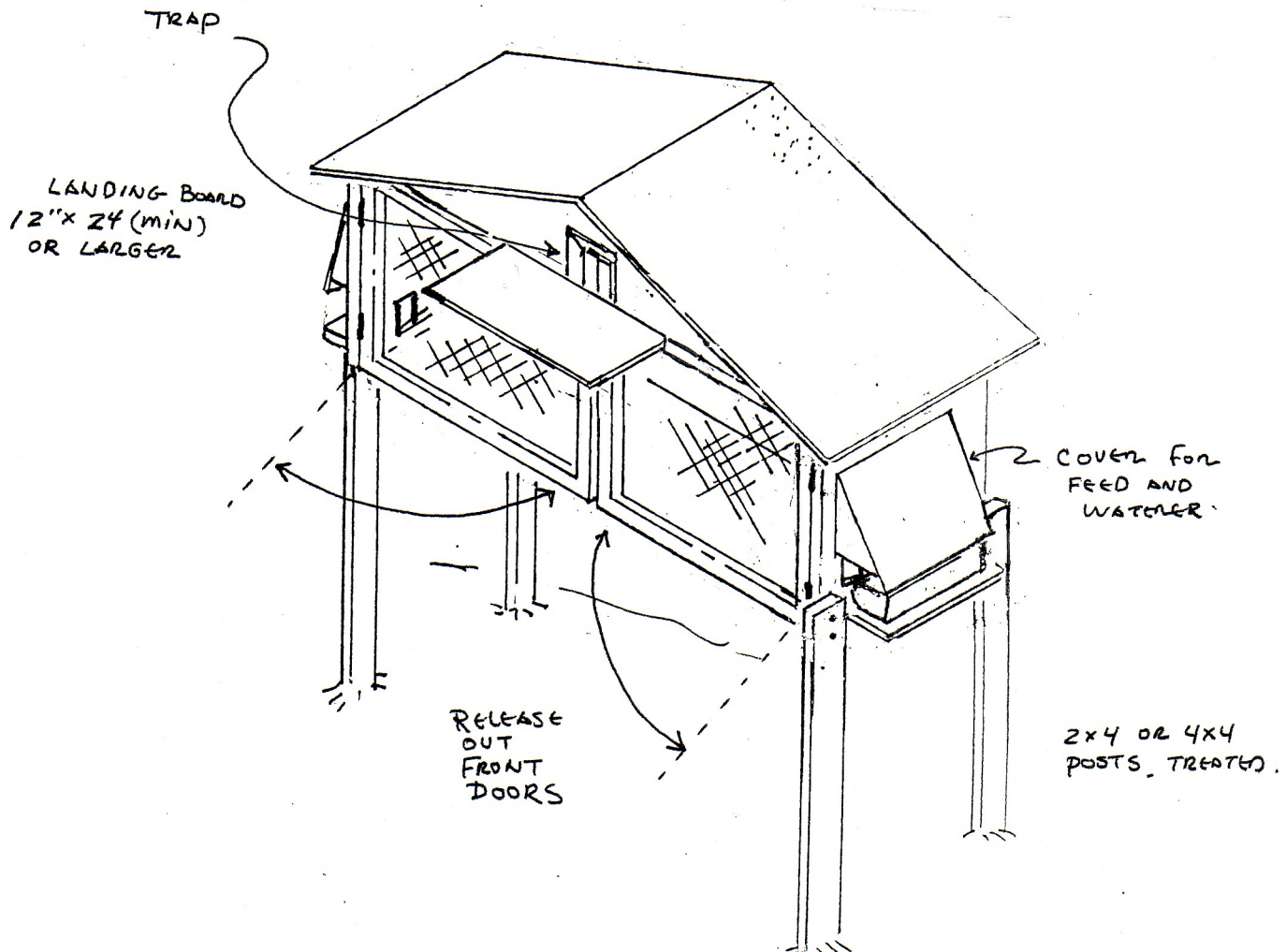

Sizes can be modified to suit.

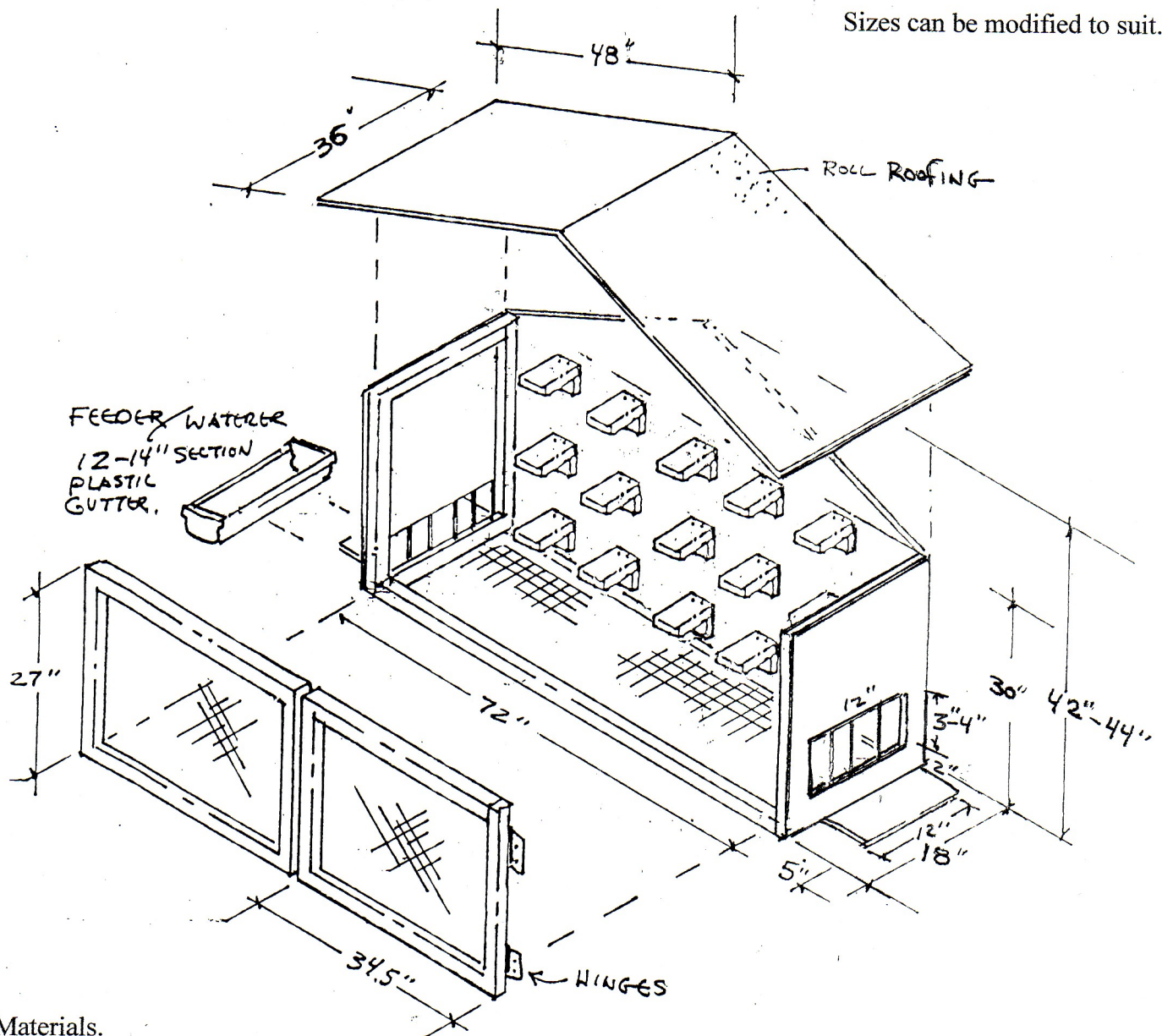

Materials.

- 10x2x 8 ft. lumber for framing.
- 2- 8ft. 1x4 or 2x4 lumber for perches.
- 2-8ft. 2x4 or 4x4, cut to 48" for posts. Bury 12-18" in ground.
- 3- Sheets of 1/4" or 3/8" Plywood (CDX, or better, outdoor grade)
- 1-36" Dowel, 1/2" dia.
- 8 ft. of roll roofing.
- 12 ft. of 36"x 1" x 1" welded wire or wire mesh
- 4 1x2" hinges, and Hasp.
- Staples
- Nails

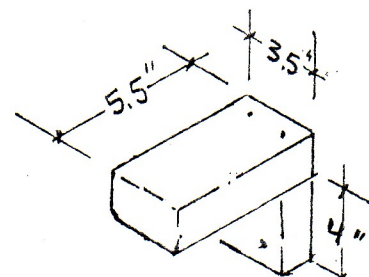

TYPICAL PERCH.
SPACE 12" CENTERS
11" ABOVE LOWER PERCH
(DIM 15)